

355 MAIN

A DESTINATION WORKPLACE



355 MAIN STREET | ARMONK, NY

Welcome to 355 Main, a 7,590-square-foot, destination workplace in the heart of Armonk. Bright and modern, it's crafted for comfort, connection, and focus—with premium furnishings, flexible suites, and a central club lounge that brings people together.

ARMONK PROFESSIONAL CENTER



Set just off Main Street in the center of Armonk, 355 and 357 Main Street create a boutique office campus designed for modern professionals. Thoughtfully planned bright, airy, and elevator-served suites are complemented by on-site parking and a serene, professional atmosphere. A short stroll to Armonk's cafés, shops, and everyday amenities, the campus blends neighborhood convenience with connectivity via I-684 and the region's major parkways.

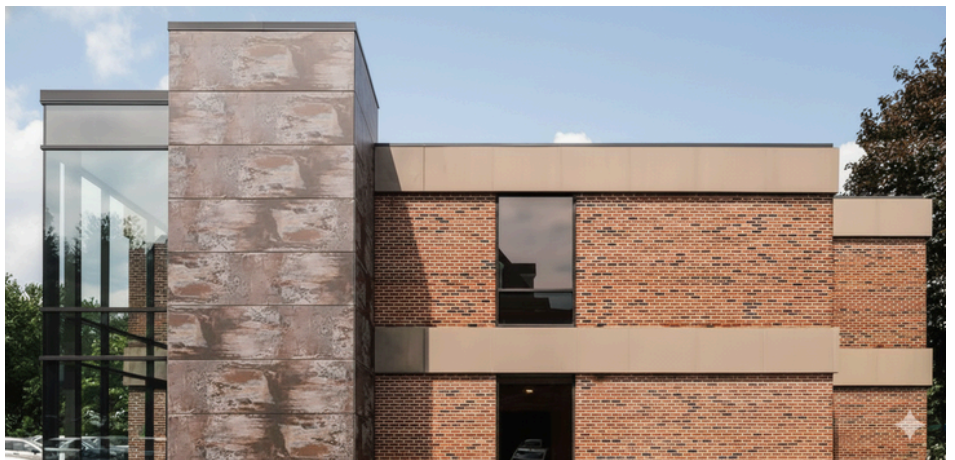

FORM FOLLOWS FUNCTION

PRIVATE OFFICES/SUITES

Fully furnished, enclosed offices sized for individuals and teams, with height-adjustable workstations, ergonomic seating, and secure storage.

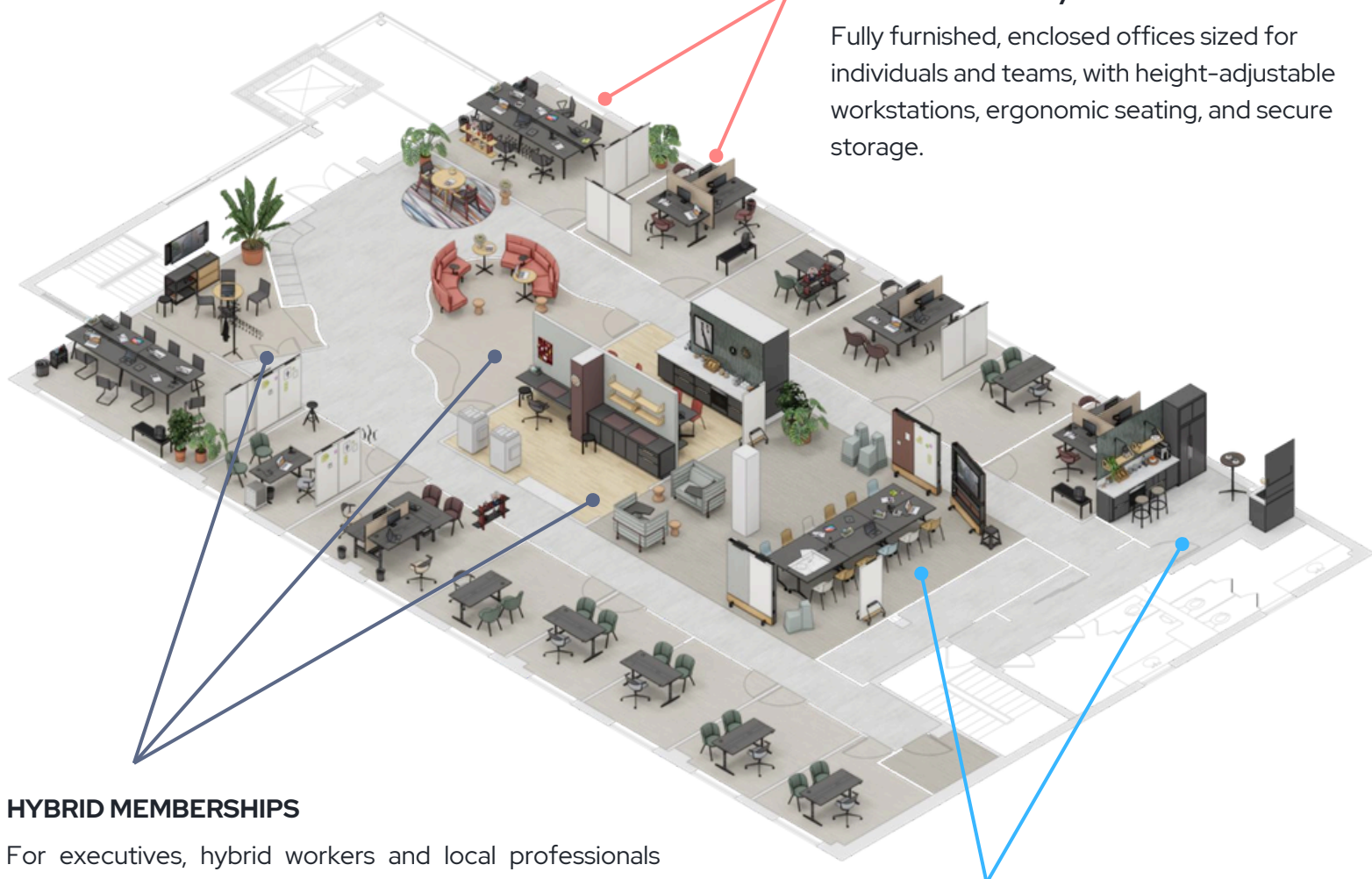

HYBRID MEMBERSHIPS

For executives, hybrid workers and local professionals who don't need a dedicated office but want access to the lounge, café, electrified work nooks and meeting rooms.

OFFSITE / EVENTS

Bookable spaces for workshops, strategy days and client events, with flexible furniture layouts and support from the 355 Main team.

WHY 355 MAIN

355 Main is designed for people who want more from an office than four walls and a door. Here, you get a beautifully curated, move-in ready space in an easy-to-access location, surrounded by like-minded professionals you actually want to bump into in the kitchen or at an evening talk.

Because it's landlord-owned and operated, everything – from furnishings to tech to service – is aligned under one vision and can flex with your team as you grow. It feels less like a traditional office, and more like a private club for getting your best work, relationships, and ideas off the ground.

MEMBERSHIP AMENITIES

>Workplace Experience

Designed for comfort, focus, and flow.

- Premium, move-in ready furnishings throughout by Vitra + Artek
- State-of-the-art ergonomic chairs and height-adjustable sit/stand desks in every office
- Naturally lit work zones with fully dimmable, scene-based LED lighting
- Dedicated focus rooms and phone rooms for quiet calls and heads-down work
- Thoughtfully zoned spaces that balance privacy, collaboration, and comfort

>Technology & Support

Sophisticated tools, seamless connectivity.

- High-speed, secure Wi-Fi across the entire suite
- Plug-and-play power integrated into desks, lounges, and communal areas (120V / USB-C/ USB-A)
- Shared print / scan station for everyday operations
- On-site ownership and management offering responsive, personalized support

>Hospitality & Daily Service

Everything you need to feel at home at work.

- Ample on-site parking for members and guests
- Stocked café lounge with filtered water, coffee, and tea
- Daily cleaning and full building maintenance
- Mail and package delivery directly to the building

CHOOSE HOW YOU WORK:

Private Office [1-20 people], starting at \$1,250 per person.

Custom Design-Led Office, design-build to suit.

Membership, starting at \$300 per person.

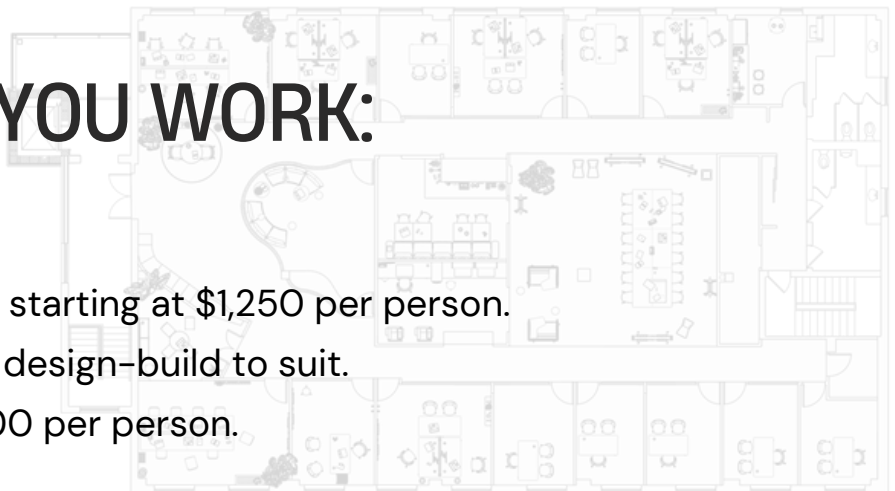

MEMBERSHIP PLANS & PRICING

> Key Terms

- **Terms:** 12–36 month terms available
- **Pricing:** Security deposit 2 months Base Rent

Office	Square Footage	Ideal Capacity	Maximum Capacity
201	246	4	4
202	280	5	5
203	194	1	2
204	141	1	2
205	131	1	1
206	208	2	3
207	208	2	3
208	123	1	1
209	129	1	1
210	135	1	2
211	159	1	2
212	135	1	1
214	135	1	2
216	104	1	1

PRIVATE SOLO OFFICE

SIZE: 120 - 150 SF

IDEAL FOR: 1 PERSON

AVAILABLE: 9 OFFICES



Engineered against static fatigue. The Mynt's weight-activated infinite posture and the Mikado's subtle rocking mechanism encourage micro-movements to keep you energized. Paired with electrified tabletops—a complete performance system designed to sustain focus.



Tyde 2, Sit-Stand Table

Ronan & Erwan Bouroullec

[> Product Page](#)

Mynt (Seat Upholstery)

Erwan Bouroullec

[> Product Page](#)

Mikado Side Chair

Edward Barber & Jay Osgerby

[> Product Page](#)

Artek Rocket Bar Stool

Eero Aarnio

[> Product Page](#)

Artek Kaari Wall Hook

Ronan & Erwan Bouroullec

[> Product Page](#)

Happy Bin Small

Michel Charlot

[> Product Page](#)

Follow Me 1

Antonio Citterio

[> Product Page](#)

Dancing Wall

(Magnetic Whiteboard)

Stephan Hürlemann

[> Product Page](#)

PRIVATE TEAM OFFICE

SIZE: 170 - 200 SF

IDEAL FOR: 2-3 PEOPLE

AVAILABLE: 2 OFFICES



TA command center for synchronized leadership. The Tyde 2 system creates a self-contained suite: sit-stand workstations for deep individual focus, plus a dedicated table for collaboration. Pivot instantly from 'heads-down' production to 'heads-up' strategy sessions.



Tyde 2, Sit-Stand Table

Ronan & Erwan Bouroullec

> [Product Page](#)

Mynt (Seat Upholstery)

Erwan Bouroullec

> [Product Page](#)

Mikado Side Chair

Edward Barber & Jay Osgerby

> [Product Page](#)

Rayonnage Mural

Jean Prouvé

> [Product Page](#)

Dancing Wall

(Magnetic Whiteboard)

Stephan Hürlemann

> [Product Page](#)

Artek Kaari Wall Hook

Ronan & Erwan Bouroullec

> [Product Page](#)

PRIVATE CUSTOM OFFICE

SIZE: 230 - 260 SF

IDEAL FOR: 4-6 PEOPLE

AVAILABLE: 2 OFFICES



A flexible canvas for high-stakes work. Lightweight touchdown tables paired with ergonomic .04 chairs create a space that pivots instantly—a polished conference room for client presentations in the morning, or a dedicated 'war room' for your team to sprint on a project.



Central Power Workstations

Joyn 2 Touchdown

Ronan & Erwan Bouroullec

> Product Page

Chair .04

Maarten Van Severen

> Product Page

Dancing Wall

(Magnetic Whiteboard)

Stephan Hürlemann

> Product Page

Drop Box

Konstantin Grcic

> Product Page

Tool Box

Aril Levy

> Product Page

Coat Rack «Hang it all»

Charles & Ray Eames

> Product Page

Happy Bin Large

Michel Charlot

> Product Page

SEMI-PRIVATE CONFERENCE

A closed meeting room with Vitra's Soft Work sofas and Dancing Wall creates a relaxed, living-room style setting for presentations and workshops. Flexible cork stools and side tables support laptops, notes, and coffee, making it ideal for hybrid meetings and creative sessions.



Soft Work Sofa

Edward Barber & Jay Osgerby

[> Product Page](#)

Soft Work Table

Edward Barber & Jay Osgerby

[> Product Page](#)

Cork Family, Model A | Model D

Jasper Morrison

[> Product Page](#)



SHARED CAFÉ

For members, the lounge doubles as an informal meeting zone—perfect for one-on-ones, quick team huddles, or welcoming a guest before moving into a private office or conference room. It’s also a natural setting for hosted moments: morning coffee gatherings, end-of-day meetups, or small community events.

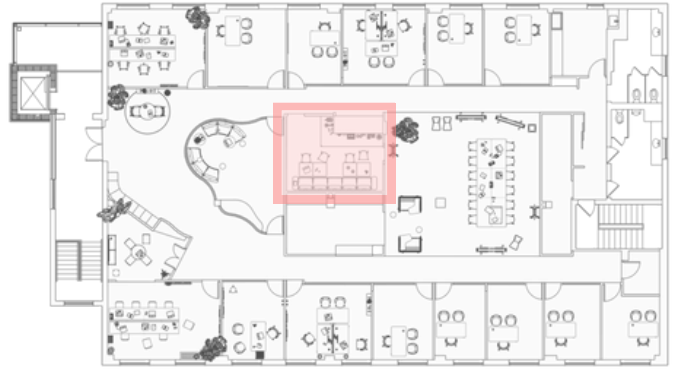

Soft Work Sofa

Edward Barber & Jay Osgerby

[> Product Page](#)

HAL RE Tube

Jasper Morrison

[> Product Page](#)

Super Fold Table

Jasper Morrison

[> Product Page](#)



SHARED DYNAMIC SPACES

The shared open office is designed as a truly dynamic space – a flexible zone that can shift from focused work to project collaboration, workshops, or town hall–style gatherings in minutes. With mobile walls, stackable seating, and agile work tables, teams can reconfigure the environment as their needs evolve, creating a living workspace.



Presentation
[10-12 people]

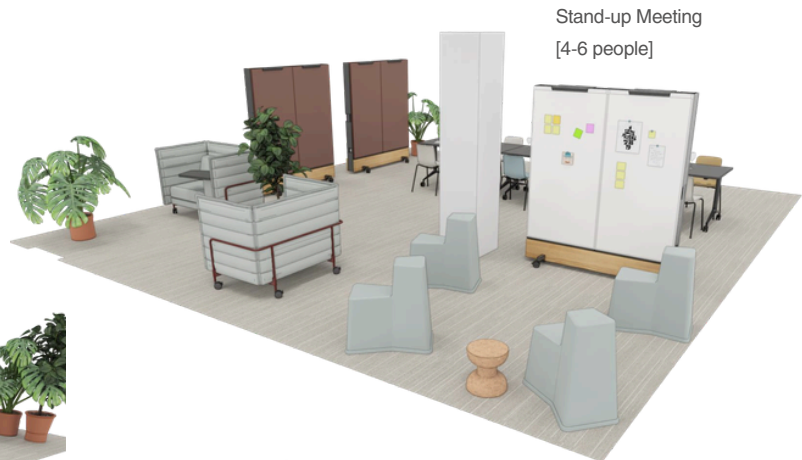

Stand-up Meeting
[4-6 people]

Meeting Space
[20 people]



Symposium
[28 people]

Dancing Wall

Stephan Hürlemann

[> Product Page](#)

Stool-Tool

Konstantin Grcic

[> Product Page](#)

MedaMorph Folding Table

Alberto Meda

[Product Page](#)

Dancing Wall Trolley

Stephan Hürlemann

[Product Page](#)

Alcove Work Lowback

Ronan & Erwan Bouroullec

[> Product Page](#)

HAL RE Tube

Jasper Morrison

[> Product Page](#)

Chap

Konstantin Grcic

[> Product Page](#)

BROKER PARTNERSHIP

We value our broker partners and are pleased to offer the following commission structure:

>Pre-Opening Commissions

(Location launch through 60 days post-launch)

- **15%** of total contract value on months 1–12
- Deal must close within **60 days** of launch

>New Deals – Standard Commissions

1. Initial term up to 12 months (including month-to-month)

- **10%** of total contract value on months 1–12

2. Initial term greater than 12 months

Broker earns the **greatest** of the following:

- **10%** of total contract value on months 1–12, **or**
- **2%** of total contract value on months 13–36, **or**
- **5%** of total contract value (flat)

>Renewals

(Deals with active broker representation)

- **2%** of total contract value

>Expansions

(Deals with active broker representation)

- **10%** of contract value growth on months 1–12
- **2%** of contract value growth on months 13–36

CONTACT US:

For tours, memberships, and availability:

212-686-2015

leasing@355main.com

www.355main.com

LOCATED IN THE HEART OF ARMONK

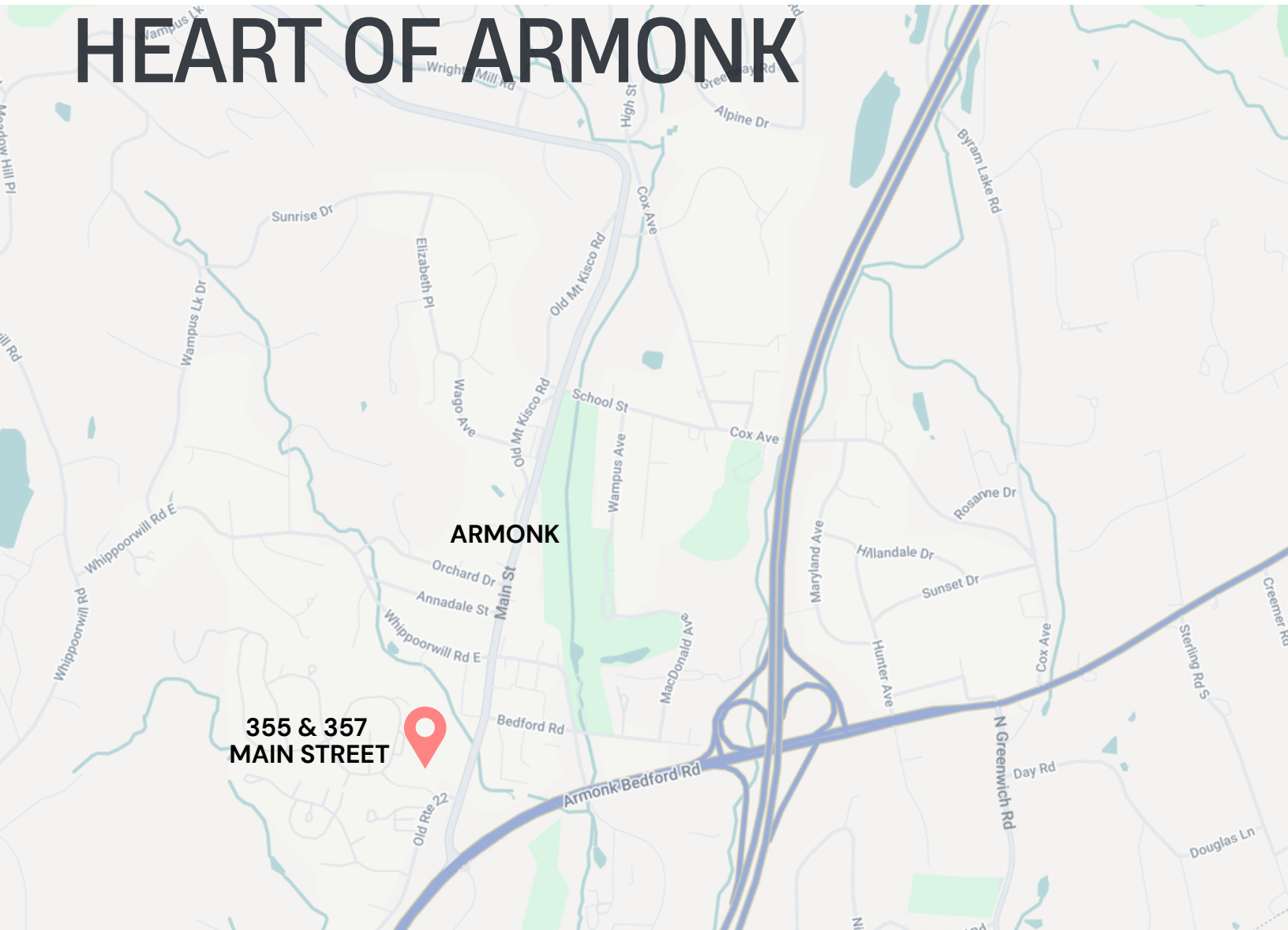

> Coffee & Cafés

Bluestone Lane Armonk Café	0.4 mi
Tazza Café	0.2 mi

> Restaurants

Meraki Taverna	0.3 mi
Casa Tequila Cocina & Bar	0.3 mi
The Beehive Restaurant	0.4 mi
Moderne Barn	0.7 mi

> Everyday Services

CVS Pharmacy	0.3 mi
Armonk Post Office (USPS)	0.2 mi

> Banking Services

Chase Bank	0.2 mi
Bank of America	0.2 mi
Citibank	0.3 mi
Wells Fargo	0.4 mi

Steps to Main Street Dining • Everyday Errands, All Right Here • Central, Connected, Convenient



CONTACT US:

For tours, memberships, and availability:

212-686-2015

leasing@355main.com

www.355main.com